



SYMBOL	DESCRIPTION
(A) L	Round recessed 6W LED downlight with silver finish and reflector. For use as emergency lighting as CHINT or equal approved.
(G) L	A stylish, recessed High-Flux-LED downlight, luminaire body in die-cast aluminium with one-piece specular anodised high purity aluminium reflector. Integral 2000lm LED Light Engine with passive cooling and remote DALI dimmable gear, light colour 3000K. As Thorn Cruz 160 LED.
(D) L	Recessed square LED 15W ceiling lamp, IP44 with diameter 400mm as CHINT or approved equivalent.
(B) L	Unique and distinctive circular luminaire for 1000lm LED with an acute angular steel bezel 'floating halo'. Concave opal polycarbonate diffuser mounted on a die-cast aluminium body with lamp connected to Quick Fix Bracket. As Thorn Thames or equal approved.
(FS) L	A versatile square luminaire for recessed mounting with LED 36W Lamp and 4000K colour temperature, CRI>80 and a lifetime of 50,000 hours @ L70 Ta 25C. As Thorn Omega LED or equal approved.
(S) L	Steel Pendant light with diameter: 380mm. Fitting height: 380mm. cord length: 1000mm. shade of black steel and cream fabric for use with LED 18W bulb as Eurolux P478 or equal approved.
(S) L	Surface mounted bulkhead with diecast silver grey aluminium body and opal polycarbonate diffuser. IP65, IK10 double wall design that will conceal cable from view. Round small with cross visor. With 1500lm (17.5W) LED and emergency options. As Thorn Eyekon LED.
(F1) L	33W LED Waterproof lighting fitting with Polycarbonate Cover, to IP65, 1200mm, 3600lumens at 110lumens/W 50.000hrs at L65, 50Hz as Philips Ledinaire Waterproof or equal approved.
(G) L	6W LED bulk head for Lift Shaft complete with all accessories as LG or equal approved.
(I) S	Intermediate switch
(6A) 1	6A 1gang 1way wallplate light switch as MK or equal approved.
(6A) 2	6A 1gang 2way wallplate light switch as MK or equal approved.
(6A) 3	6A 2gang 1way wallplate light switch as MK or equal approved.
(6A) 4	6A 3gang 2way wallplate light switch as MK or equal approved.
(6A) 5	6A 2gang 2way wallplate light switch as MK or equal approved.

**PROJECT**  
**PROPOSED OFFICE DEVELOPMENT FOR UNFPA ON PLOT 61 YUSUF LULE ROAD**

**CLIENT**  
 **UNFPA, United Nations Population Fund**  
 Kampala, Uganda

**CONSULTANT**  
 **PROESS Consulting Engineers**  
 Plot 104, Semawata Road  
 info@proess.ug  
 www.proess.ug  
 +256392178690

NO REVISIONS		
No	Date	Descriptions

DRAWING TITLE			
ELECTRICAL INSTALLATIONS: GROUND FLOOR: LIGHTING			
DESIGNED BY CATHERINE	DRAWN BY CATHERINE	JOB NO	DRG NO E01
CHECKED BY O.P	SCALE NTS	DATE AUG-2024	PAPER SIZE A1

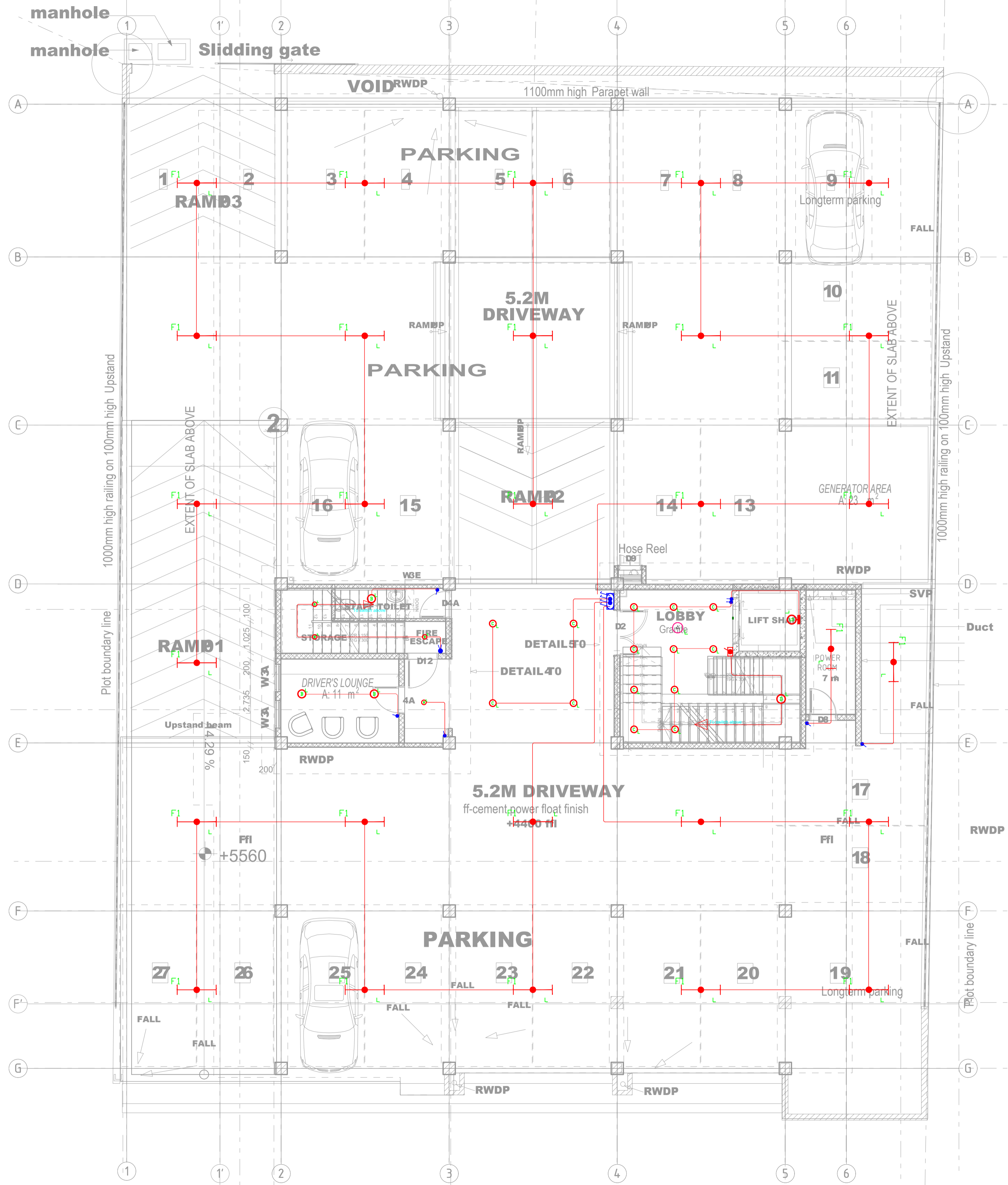

SYMBOL	DESCRIPTION
	Round recessed 6W LED downlight with silver finish and reflector. For use as emergency lighting as CHINT or equal approved.
	A stylish, recessed High-Flux-LED downlight, luminaire body in die-cast aluminium with one-piece specular anodised high purity aluminium reflector. Integral 2000lm LED Light Engine with passive cooling and remote DALI dimmable gear, light colour 3000K. As Thorn Cruz 160 LED.
	Recessed square LED 15W ceiling lamp, IP44 with diameter 400mm as CHINT or approved equivalent.
	Unique and distinctive circular luminaire for 1000lm LED with an acute angular steel bezel 'floating halo'. Concave opal polycarbonate diffuser mounted on a die-cast aluminium body with lamp connected to Quick Fix Bracket. As Thorn Thames or equal approved.
	A versatile square luminaire for recessed mounting with LED 36W Lamp and 4000K colour temperature, CRI>80 and a lifetime of 50,000 hours @ L70 Ta 25C. As Thorn Omega LED or equal approved.
	Steel Pendant light with diameter: 380mm, Fitting height: 380mm, cord length: 1000mm, shade of black steel and cream fabric for use with LED 18W bulb as Eurolux P478 or equal approved.
	Surface mounted bulkhead with diecast silver grey aluminium body and opal polycarbonate diffuser. IP65, IK10 double wall design that will conceal cable from view. Round small with cross visor. With 1500lm (17.5W) LED and emergency options. As Thorn Eyekon LED.
	33W LED Waterproof lighting fitting with Polycarbonate Cover, to IP65, 1200mm, 3600Lumens at 110Lumens/W 50,000hrs at L65, 50Hz as Philips Ledinaire Waterproof or equal approved.
	6W LED bulk head for Lift Shaft complete with all accessories as LG or equal approved.
	Intermediate switch
	6A 1gang 1way wallplate light switch as MK or equal approved.
	6A 1gang 2way wallplate light switch as MK or equal approved.
	6A 2gang 1way wallplate light switch as MK or equal approved.
	6A 3gang 1way wallplate light switch as MK or equal approved.
	6A 3gang 2way wallplate light switch as MK or equal approved.
	6A 2gang 2way wallplate light switch as MK or equal approved.

PROJECT  
**PROPOSED OFFICE DEVELOPMENT FOR UNFPA ON PLOT 61 YUSUF LULE ROAD**

CLIENT  
**UNFPA, United Nations Population Fund**  
 Kampala, Uganda

CONSULTANT  
**PROESS**  
 Consulting Engineers  
 Plot 104, Semawata Road  
 info@proess.ug  
 www.proess.ug  
 +256392178690

NO REVISIONS		
No	Date	Descriptions

DRAWING TITLE			
ELECTRICAL INSTALLATIONS: FIRST FLOOR: LIGHTING			
DESIGNED BY CATHERINE	DRAWN BY CATHERINE	JOB NO	DRG NO E02
CHECKED BY O.P	SCALE NTS	DATE AUG-2024	PAPER SIZE A1



SYMBOL	DESCRIPTION
	Round recessed 6W LED downlight with silver finish and reflector. For use as emergency lighting as CHINT or equal approved.
	A stylish, recessed High-Flux-LED downlight, luminaire body in die-cast aluminium with one-piece specular anodised high purity aluminium reflector. Integral 2000lm LED Light Engine with passive cooling and remote DALI dimmable gear, light colour 3000K. As Thorn Cruz 160 LED.
	Recessed square LED 15W ceiling lamp, IP44 with diameter 400mm as CHINT or approved equivalent.
	Unique and distinctive circular luminaire for 1000lm LED with an acute angular steel bezel 'floating halo'. Concave opal polycarbonate diffuser mounted on a die-cast aluminium body with lamp connected to Quick Fix Bracket. As Thorn Thames or equal approved.
	A versatile square luminaire for recessed mounting with LED 36W Lamp and 4000K colour temperature, CRI>80 and a lifetime of 50,000 hours @ L70 Ta 25C. As Thorn Omega LED or equal approved.
	Steel Pendant light with diameter: 380mm, Fitting height: 380mm, cord length: 1000mm, shade of black steel and cream fabric for use with LED 18W bulb as Eurolux P478 or equal approved.
	Surface mounted bulkhead with diecast silver grey aluminium body and opal polycarbonate diffuser. IP65, IK10 double wall design that will conceal cable from view. Round small with cross visor. With 1500lm (17.5W) LED and emergency options. As Thorn Eyekon LED.
	33W LED Waterproof lighting fitting with Polycarbonate Cover, to IP65, 1200mm, 3600Lumens at 110Lumens/W 50,000hrs at L65, 50Hz as Philips Ledinaire Waterproof or equal approved.
	6W LED bulk head for Lift Shaft complete with all accessories as LG or equal approved.
	Intermediate switch
	6A 1gang 1way wallplate light switch as MK or equal approved.
	6A 1gang 2way wallplate light switch as MK or equal approved.
	6A 2gang 1way wallplate light switch as MK or equal approved.
	6A 3gang 1way wallplate light switch as MK or equal approved.
	6A 3gang 2way wallplate light switch as MK or equal approved.
	6A 2gang 2way wallplate light switch as MK or equal approved.

**PROJECT**  
**PROPOSED OFFICE DEVELOPMENT FOR UNFPA ON PLOT 61 YUSUF LULE ROAD**

**CLIENT**  
**UNFPA, United Nations Population Fund**  
 Kampala, Uganda

**CONSULTANT**  
**PROESS**  
 Consulting Engineers  
 Plot 104, Semawata Road  
 info@proess.ug  
 www.proess.ug  
 +256392178690

NO			REVISIONS			DRAWING TITLE			
						ELECTRICAL INSTALLATIONS: SECOND FLOOR: LIGHTING			
No	Date	Descriptions	DESIGNED BY	DRAWN BY	JOB NO	DRG NO			
			CATHERINE	CATHERINE		E03			
			CHECKED BY	SCALE	DATE	PAPER SIZE			
			O.P	NTS	AUG-2024	A1			





SYMBOL	DESCRIPTION
	Round recessed 6W LED downlight with silver finish and reflector. For use as emergency lighting as CHINT or equal approved.
	A stylish, recessed High-Flux-LED downlight, luminaire body in die-cast aluminium with one-piece specular anodised high purity aluminium reflector. Integral 2000lm LED Light Engine with passive cooling and remote DALI dimmable gear, light colour 3000K. As Thorn Cruz 160 LED.
	Recessed square LED 15W ceiling lamp, IP44 with diameter 400mm as CHINT or approved equivalent.
	Unique and distinctive circular luminaire for 1000lm LED with an acute angular steel bezel 'floating halo'. Concave opal polycarbonate diffuser mounted on a die-cast aluminium body with lamp connected to Quick Fix Bracket. As Thorn Thames or equal approved.
	A versatile square luminaire for recessed mounting with LED 36W Lamp and 4000K colour temperature, CRI>80 and a lifetime of 50,000 hours @ L70 Ta 25C. As Thorn Omega LED or equal approved.
	Steel Pendant light with diameter 380mm. Fitting height: 380mm, cord length: 1000mm, shade of black steel and cream fabric for use with LED 15W bulb as Eurolux P478 or equal approved.
	Surface mounted bulkhead with diecast silver aluminium body and opal polycarbonate diffuser. IP65, IK10 double wall design that will conceal cable from view. Round small with cross visor. With 1500lm (17.5W) LED and emergency options. As Thorn Eyekon LED.
	33W LED Waterproof lighting fitting with Polycarbonate Cover, to IP65, 1200mm, 3600Lumens at 110Lumens/W 50,000hrs at L65, 50Hz as Philips Ledinaire Waterproof or equal approved.
	6W LED bulk head for Lift Shaft complete with all accessories as LG or equal approved.
	Intermediate switch
	6A 1gang 1way wallplate light switch as MK or equal approved.
	6A 1gang 2way wallplate light switch as MK or equal approved.
	6A 2gang 1way wallplate light switch as MK or equal approved.
	6A 3gang 1way wallplate light switch as MK or equal approved.
	6A 3gang 2way wallplate light switch as MK or equal approved.
	6A 2gang 2way wallplate light switch as MK or equal approved.

**PROJECT**  
**PROPOSED OFFICE DEVELOPMENT FOR UNFPA ON PLOT 61 YUSUF LULE ROAD**

**CLIENT**  
**UNFPA, United Nations Population Fund**  
 Kampala, Uganda

**CONSULTANT**  
**PROESS**  
 Consulting Engineers  
 Plot 104, Semawata Road  
 info@proess.ug  
 www.proess.ug  
 +256392178690

NO REVISIONS		
No	Date	Descriptions

DRAWING TITLE			
ELECTRICAL INSTALLATIONS: FOURTH FLOOR: LIGHTING			
DESIGNED BY <b>CATHERINE</b>	DRAWN BY <b>CATHERINE</b>	JOB NO	DRG NO <b>E05</b>
CHECKED BY <b>O.P</b>	SCALE <b>NTS</b>	DATE <b>AUG-2024</b>	PAPER SIZE <b>A1</b>

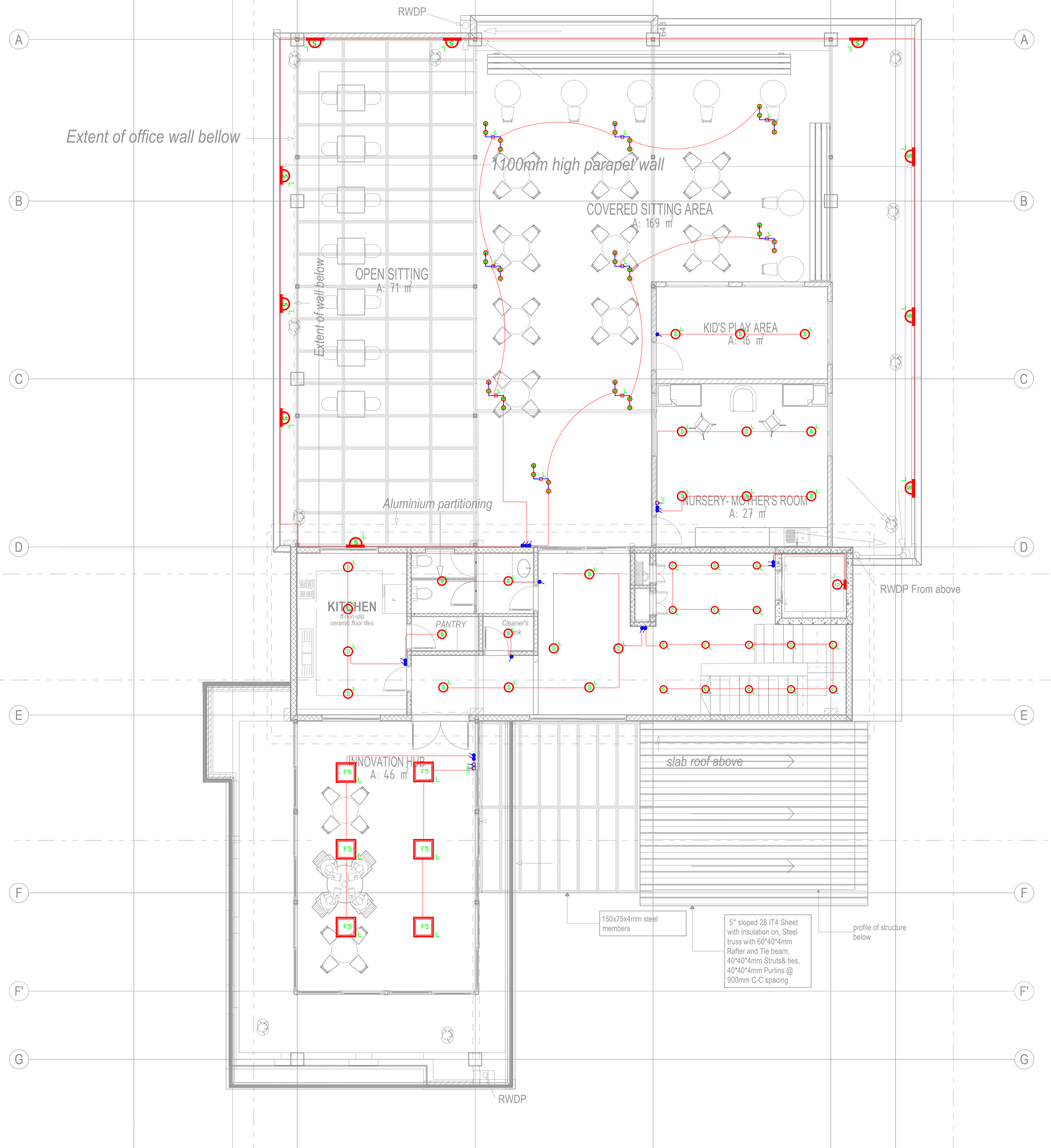

SYMBOL	DESCRIPTION
(A) L	Round recessed 6W LED downlight with silver finish and reflector. For use as emergency lighting as CHINT or equal approved.
(G) L	A stylish, recessed High-Flux-LED downlight, luminaire body in die-cast aluminium with one-piece specular anodised high purity aluminium reflector. Integral 2000lm LED Light Engine with passive cooling and remote DALI dimmable gear, light colour 3000K. As Thorn Cruz 160 LED.
(D) L	Recessed square LED 15W ceiling lamp, IP44 with diameter 400mm as CHINT or approved equivalent.
(H) L	Unique and distinctive circular luminaire for 1000lm LED with an acute angular steel bezel 'floating halo'. Concave opal polycarbonate diffuser mounted on a die-cast aluminium body with lamp connected to Quick Fix Bracket. As Thorn Thames or equal approved.
(FS) L	A versatile square luminaire for recessed mounting with LED 36W Lamp and 4000K colour temperature, CRI>80 and a lifetime of 50,000 hours @ L70 Ta 25C. As Thorn Omega LED or equal approved.
(S) L	Steel Pendant light with diameter: 380mm, Fitting height: 380mm, cord length: 1000mm, shade of black steel and cream fabric for use with LED 18W bulb as Eurolux P478 or equal approved.
(S) L	Surface mounted bulkhead with diecast silver grey aluminium body and opal polycarbonate diffuser. IP65, IK10 double wall design that will conceal cable from view. Round small with cross visor. With 1500lm (17.5W) LED and emergency options. As Thorn Eyekon LED.
(F) L	33W LED Waterproof lighting fitting with Polycarbonate Cover, to IP65, 1200mm, 3600Lumens at 110Lumens/W 50,000hrs at L65, 50Hz as Philips Ledinaire Waterproof or equal approved.
(G) L	6W LED bulk head for Lift Shaft complete with all accessories as LG or equal approved.
(S)	Intermediate switch
(S)	6A 1gang 1way wallplate light switch as MK or equal approved.
(S)	6A 1gang 2way wallplate light switch as MK or equal approved.
(S)	6A 2gang 1way wallplate light switch as MK or equal approved.
(S)	6A 3gang 1way wallplate light switch as MK or equal approved.
(S)	6A 3gang 2way wallplate light switch as MK or equal approved.
(S)	6A 2gang 2way wallplate light switch as MK or equal approved.

**PROJECT**  
**PROPOSED OFFICE DEVELOPMENT FOR UNFPA ON PLOT 61 YUSUF LULE ROAD**

**CLIENT**  
 **UNFPA, United Nations Population Fund**  
 Kampala, Uganda

**CONSULTANT**  
 **PROESS**  
 Consulting Engineers  
 Plot 104, Semawata Road  
 info@proess.ug  
 www.proess.ug  
 +256392178690

NO REVISIONS		
No	Date	Descriptions

DRAWING TITLE			
ELECTRICAL INSTALLATIONS: TERRACE FLOOR: LIGHTING			
DESIGNED BY <b>CATHERINE</b>	DRAWN BY <b>CATHERINE</b>	JOB NO	DRG NO <b>E06</b>
CHECKED BY <b>O.P</b>	SCALE <b>NTS</b>	DATE <b>AUG-2024</b>	PAPER SIZE <b>A1</b>

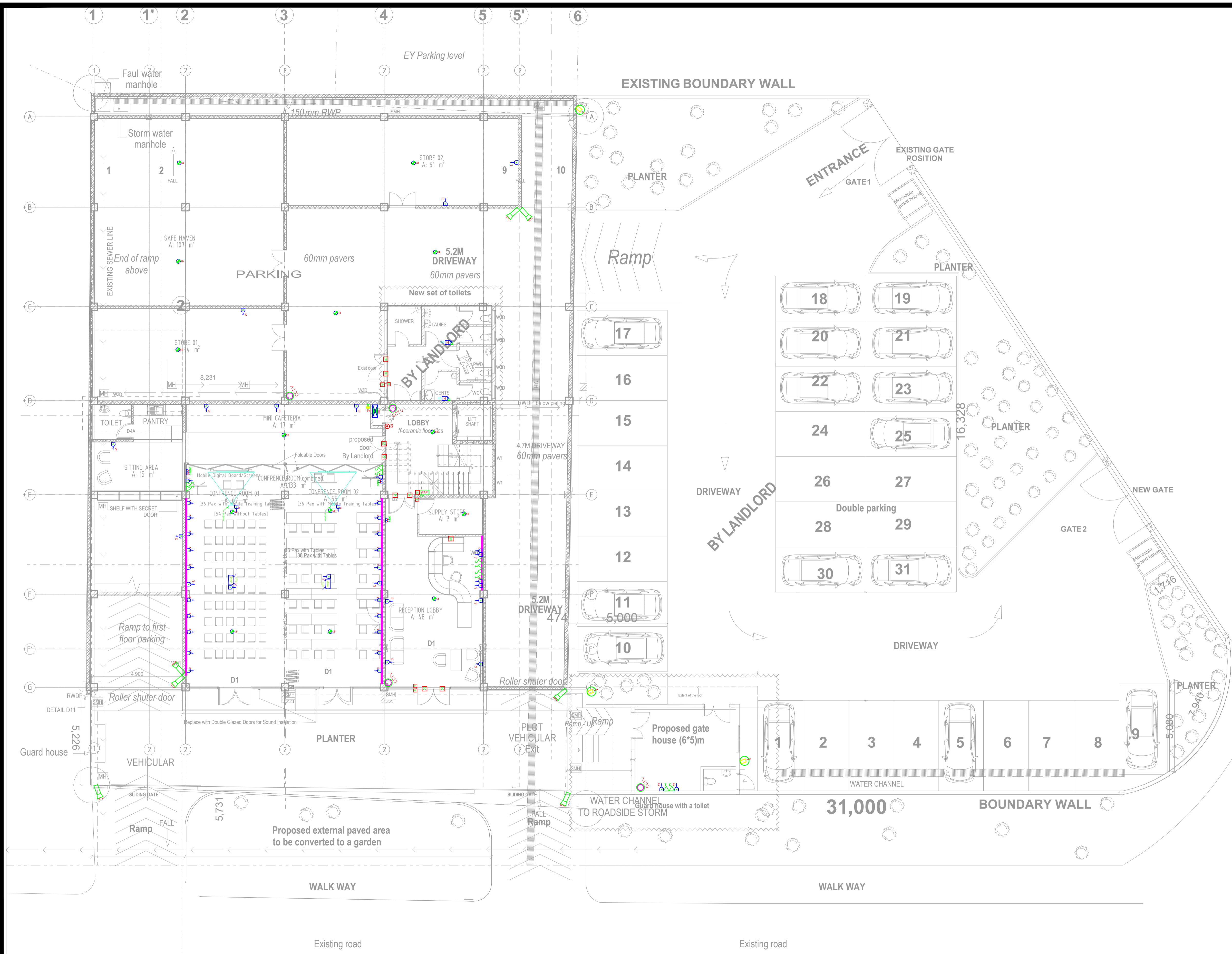

	13A two Gang switched Socket outlet on wall.
	13A two Gang waterproof switched Socket outlet on wall.
	13A two Gang switched Socket outlet on trunking
	Cooker Control Unit.
	consumer unit
	Distribution board
	Fire Alarm sounder
	Optical Smoke detector
	Optical Heat detector
	Breakglass unit
	Bullet type CCTV Camera
	Dome shaped CCTV Camera
	PTZ CCTV
	Data/computer point
	Voice/telephone point
	TV point
	Fire alarm panel
	3 Section PVC Trunking overall section 167 x 50mm as marshall-tuffex sterling trunking profile 2 or equal approved complete with couplers, end cap, internal/external bends, upward/down ward flat tees and all accessories
	Electronic magnetic contacts
	Biometric card Reader
	Emergency Door release
	Push to release
	Door magnetic control
	Strobe Light & siren for intrusion detection system
	Motion Sensor for intrusion detection system

**PROJECT**  
**PROPOSED OFFICE DEVELOPMENT FOR UNFPA ON PLOT 61 YUSUF LULE ROAD**

**CLIENT**  
**UNFPA, United Nations Population Fund**  
 Kampala, Uganda

**CONSULTANT**  
**PROESS** Consulting Engineers  
 Plot 104, Semawata Road  
 info@proess.ug  
 www.proess.ug  
 +256392178690

NO			REVISIONS		
No	Date	Descriptions			

<b>DRAWING TITLE</b>				
ELECTRICAL INSTALLATIONS: GROUND FLOOR: SMALL POWER, ACCESS CONTROL, FIRE DETECTION				
DESIGNED BY CATHERINE	DRAWN BY CATHERINE	JOB NO	DRG NO E07	
CHECKED BY O.P	SCALE NTS	DATE AUG-2024	PAPER SIZE A1	



	13A two Gang switched Socket outlet on wall.
	13A two Gang waterproof switched Socket outlet on wall.
	13A two Gang switched Socket outlet on trunking
	Cooker Control Unit.
	consumer unit
	Distribution board
	Fire Alarm sounder
	Optical Smoke detector
	Optical Heat detector
	Breakglass unit
	Bullet type CCTV Camera
	Dome shaped CCTV Camera
	PTZ CCTV
	Data/computer point
	Voice/telephone point
	TV point
	Fire alarm pannel
	3 Section PVC Trunking overall section 167 x 50mm as marshall-tufflex sterling trunking profile 2 or equal approved complete with couplers,end cap,internal/external bends, upward/down ward flat tees and all accessories
	Electronic magnetic contacts
	Biometric card Reader
	Emergency Door release
	Push to release
	Door magnetic control
	Strobe Light & siren for intrusion detection system
	Motion Sensor for intrusion detection system

PROJECT  
**PROPOSED OFFICE  
 DEVELOPMENT FOR UNFPA  
 ON PLOT 61 YUSUF LULE ROAD**

CLIENT  
**UNFPA, United Nations  
 Population Fund  
 Kampala, Uganda**

CONSULTANT  
**Plot 104, Semawata Road  
 info@proess.ug  
 www.proess.ug  
 +256392178690**

NO REVISIONS		
No	Date	Descriptions

DRAWING TITLE			
ELECTRICAL INSTALLATIONS: FIRST FLOOR: SMALL POWER, ACCESS CONTROL FIRE DETECTION			
DESIGNED BY <b>CATHERINE</b>	DRAWN BY <b>CATHERINE</b>	JOB NO	DRG NO E08
CHECKED BY <b>O.P</b>	SCALE NTS	DATE AUG-2024	PAPER SIZE A1



	13A two Gang switched Socket outlet on wall.
	13A two Gang waterproof switched Socket outlet on wall.
	13A two Gang switched Socket outlet on trunking
	Cooker Control Unit.
	consumer unit
	Distribution board
	Fire Alarm sounder
	Optical Smoke detector
	Optical Heat detector
	Breakglass unit
	Bullet type CCTV Camera
	Dome shaped CCTV Camera
	PTZ CCTV
	Data/computer point
	Voice/telephone point
	TV point
	Fire alarm panel
	3 Section PVC Trunking overall section 167 x 50mm as marshal-tufflex sterling trunking profile 2 or equal approved complete with couplers, end cap, internal/external bends, upward/down ward flat tees and all accessories
	Electronic magnetic contacts
	Biometric card Reader
	Emergency Door release
	Push to release
	Door magnetic control
	Strobe Light & siren for intrusion detection system
	Motion Sensor for intrusion detection system

PROJECT  
**PROPOSED OFFICE  
 DEVELOPMENT FOR UNFPA  
 ON PLOT 61 YUSUF LULE ROAD**

CLIENT  
  
**UNFPA, United Nations  
 Population Fund  
 Kampala, Uganda**

CONSULTANT  
  
**PROESS  
 Consulting Engineers**  
 Plot 104, Semawata Road  
 info@proess.ug  
 www.proess.ug  
 +256392178690

NO REVISIONS		
No	Date	Descriptions

DRAWING TITLE			
ELECTRICAL INSTALLATIONS: SECOND FLOOR: SMALL POWER, ACCESS CONTROL FIRE DETECTION			
DESIGNED BY CATHERINE	DRAWN BY CATHERINE	JOB NO	DRG NO E09
CHECKED BY O.P	SCALE NTS	DATE AUG-2024	PAPER SIZE A1



	13A two Gang switched Socket outlet on wall.
	13A two Gang waterproof switched Socket outlet on wall.
	13A two Gang switched Socket outlet on trunking
	Cooker Control Unit.
	consumer unit
	Distribution board
	Fire Alarm sounder
	Optical Smoke detector
	Optical Heat detector
	Breakglass unit
	Bullet type CCTV Camera
	Dome shaped CCTV Camera
	PTZ CCTV
	Data/computer point
	Voice/telephone point
	TV point
	Fire alarm panel
	3 Section PVC Trunking overall section 167 x 50mm as marshall-tufflex sterling trunking profile 2 or equal approved complete with couplers, end cap, internal/external bends, upward/down ward flat tees and all accessories
	Electronic magnetic contacts
	Biometric card Reader
	Emergency Door release
	Push to release
	Door magnetic control
	Strobe Light & siren for intrusion detection system
	Motion Sensor for intrusion detection system

**PROJECT**  
**PROPOSED OFFICE DEVELOPMENT FOR UNFPA ON PLOT 61 YUSUF LULE ROAD**

**CLIENT**  
**UNFPA, United Nations Population Fund**  
 Kampala, Uganda

**CONSULTANT**  
**PROESS** Consulting Engineers  
 Plot 104, Semawata Road  
 info@proess.ug  
 www.proess.ug  
 +256392178690

NO REVISIONS		
No	Date	Descriptions

DRAWING TITLE			
ELECTRICAL INSTALLATIONS: THIRD FLOOR: SMALL POWER, ACCESS CONTROL FIRE DETECTION			
DESIGNED BY <b>CATHERINE</b>	DRAWN BY <b>CATHERINE</b>	JOB NO	DRG NO <b>E10</b>
CHECKED BY <b>O.P</b>	SCALE <b>NTS</b>	DATE <b>AUG-2024</b>	PAPER SIZE <b>A1</b>



	13A two Gang switched Socket outlet on wall.
	13A two Gang waterproof switched Socket outlet on wall.
	13A two Gang switched Socket outlet on trunking
	Cooker Control Unit.
	consumer unit
	Distribution board
	Fire Alarm sounder
	Optical Smoke detector
	Optical Heat detector
	Breakglass unit
	Bullet type CCTV Camera
	Dome shaped CCTV Camera
	PTZ CCTV
	Data/computer point
	Voice/telephone point
	TV point
	Fire alarm panel
	3 Section PVC Trunking overall section 167 x 50mm as marshall-tufflex sterling trunking profile 2 or equal approved complete with couplers, end cap, internal/external bends, upward/down ward flat tees and all accessories
	Electronic magnetic contacts
	Biometric card Reader
	Emergency Door release
	Push to release
	Door magnetic control
	Strobe Light & siren for intrusion detection system
	Motion Sensor for intrusion detection system

**PROJECT**  
**PROPOSED OFFICE DEVELOPMENT FOR UNFPA ON PLOT 61 YUSUF LULE ROAD**

**CLIENT**  
**UNFPA, United Nations Population Fund**  
 Kampala, Uganda

**CONSULTANT**  
**PROESS**  
 Consulting Engineers  
 Plot 104, Semawata Road  
 info@proess.ug  
 www.proess.ug  
 +256392178690

NO REVISIONS		
No	Date	Descriptions

DRAWING TITLE			
ELECTRICAL INSTALLATIONS: FOURTH FLOOR: SMALL POWER, ACCESS CONTROL FIRE DETECTION			
DESIGNED BY <b>CATHERINE</b>	DRAWN BY <b>CATHERINE</b>	JOB NO	DRG NO <b>E11</b>
CHECKED BY <b>O.P</b>	SCALE <b>NTS</b>	DATE <b>AUG-2024</b>	PAPER SIZE <b>A1</b>

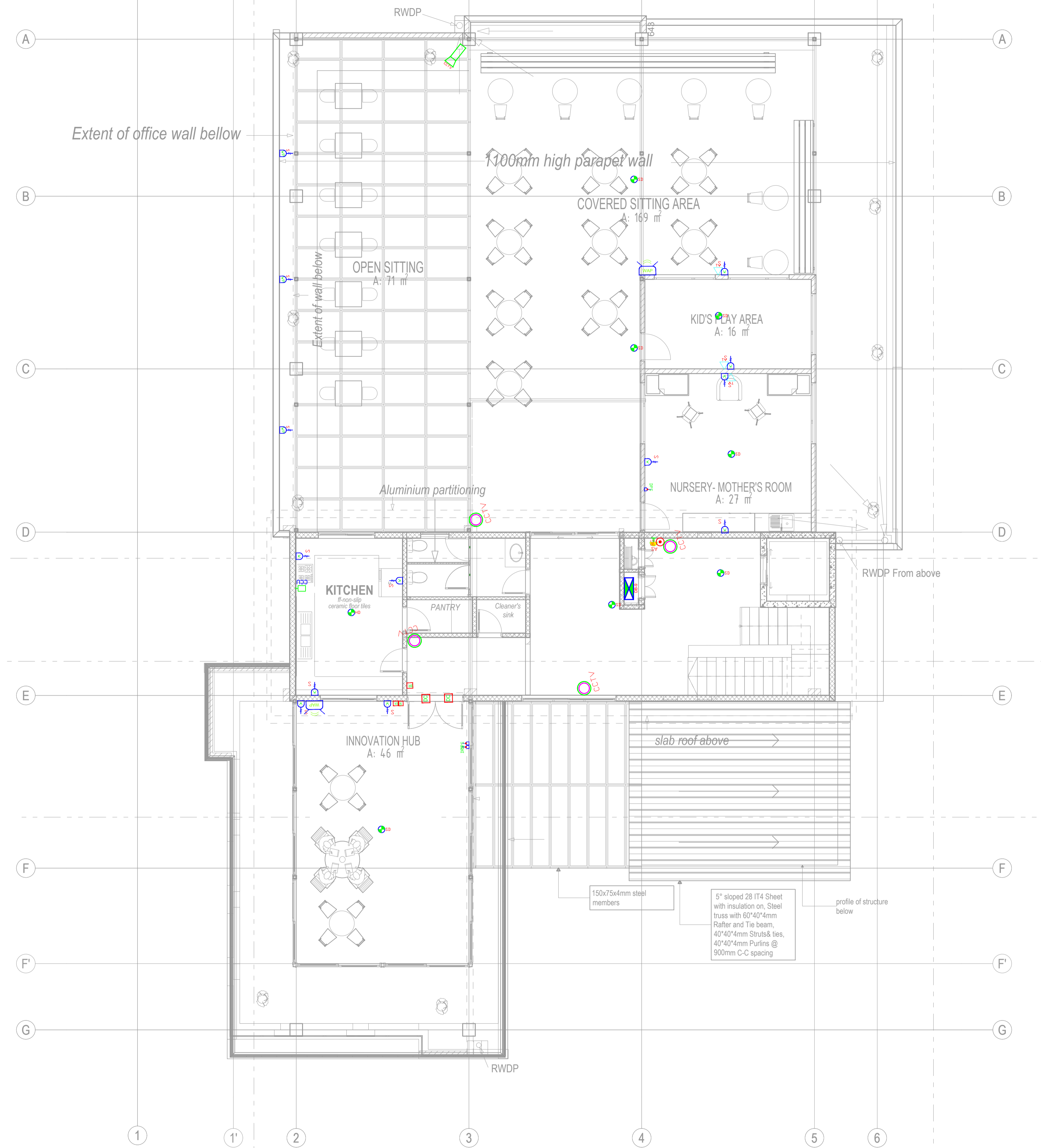

	13A two Gang switched Socket outlet on wall.
	13A two Gang waterproof switched Socket outlet on wall.
	13A two Gang switched Socket outlet on trunking
	Cooker Control Unit.
	consumer unit
	Distribution board
	Fire Alarm sounder
	Optical Smoke detector
	Optical Heat detector
	Breakglass unit
	Bullet type CCTV Camera
	Dome shaped CCTV Camera
	PTZ CCTV
	Data/computer point
	Voice/telephone point
	TV point
	Fire alarm panel
	3 Section PVC Trunking overall section 167 x 50mm as marshall-tufflex sterling trunking profile 2 or equal approved complete with couplers, end cap, internal/external bends, upward/down ward flat tees and all accessories
	Electronic magnetic contacts
	Biometric card Reader
	Emergency Door release
	Push to release
	Door magnetic control
	Strobe Light & siren for intrusion detection system
	Motion Sensor for intrusion detection system

**PROJECT**  
**PROPOSED OFFICE DEVELOPMENT FOR UNFPA ON PLOT 61 YUSUF LULE ROAD**

**CLIENT**  
**UNFPA, United Nations Population Fund**  
 Kampala, Uganda

**CONSULTANT**  
**PROESS Consulting Engineers**  
 Plot 104, Semawata Road  
 info@proess.ug  
 www.proess.ug  
 +256392178690

NO REVISIONS		
No	Date	Descriptions

<b>DRAWING TITLE</b>			
ELECTRICAL INSTALLATIONS: TERRACE FLOOR: SMALL POWER, ACCESS CONTROL FIRE DETECTION			
DESIGNED BY CATHERINE	DRAWN BY CATHERINE	JOB NO	DRG NO E12
CHECKED BY O.P	SCALE NTS	DATE AUG-2024	PAPER SIZE A1

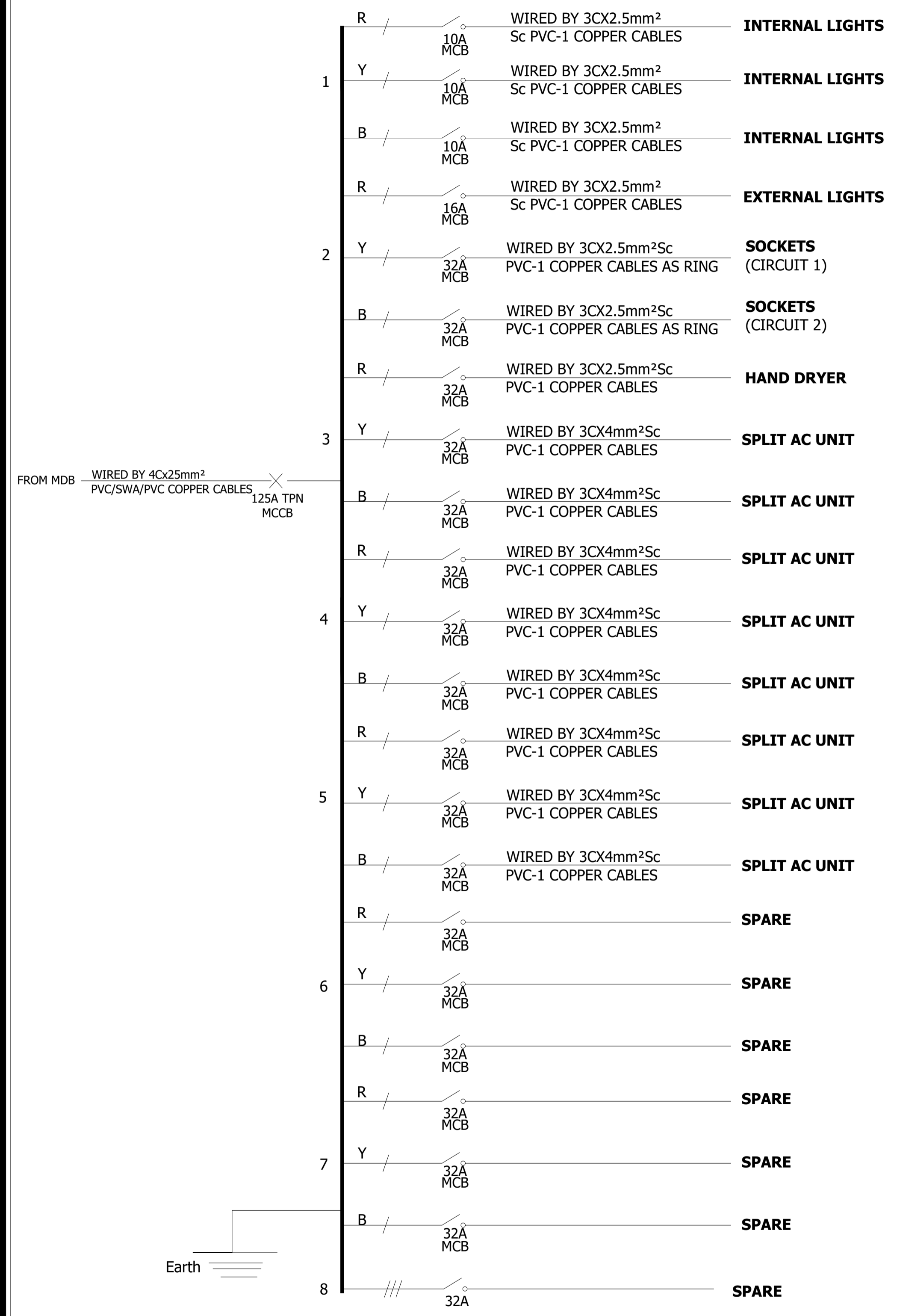

125A, 8-WAY TPN MCCB DISTRIBUTION BOARD (DB-1) RECESSED IN WALL IN DUCT ON GROUND FLOOR

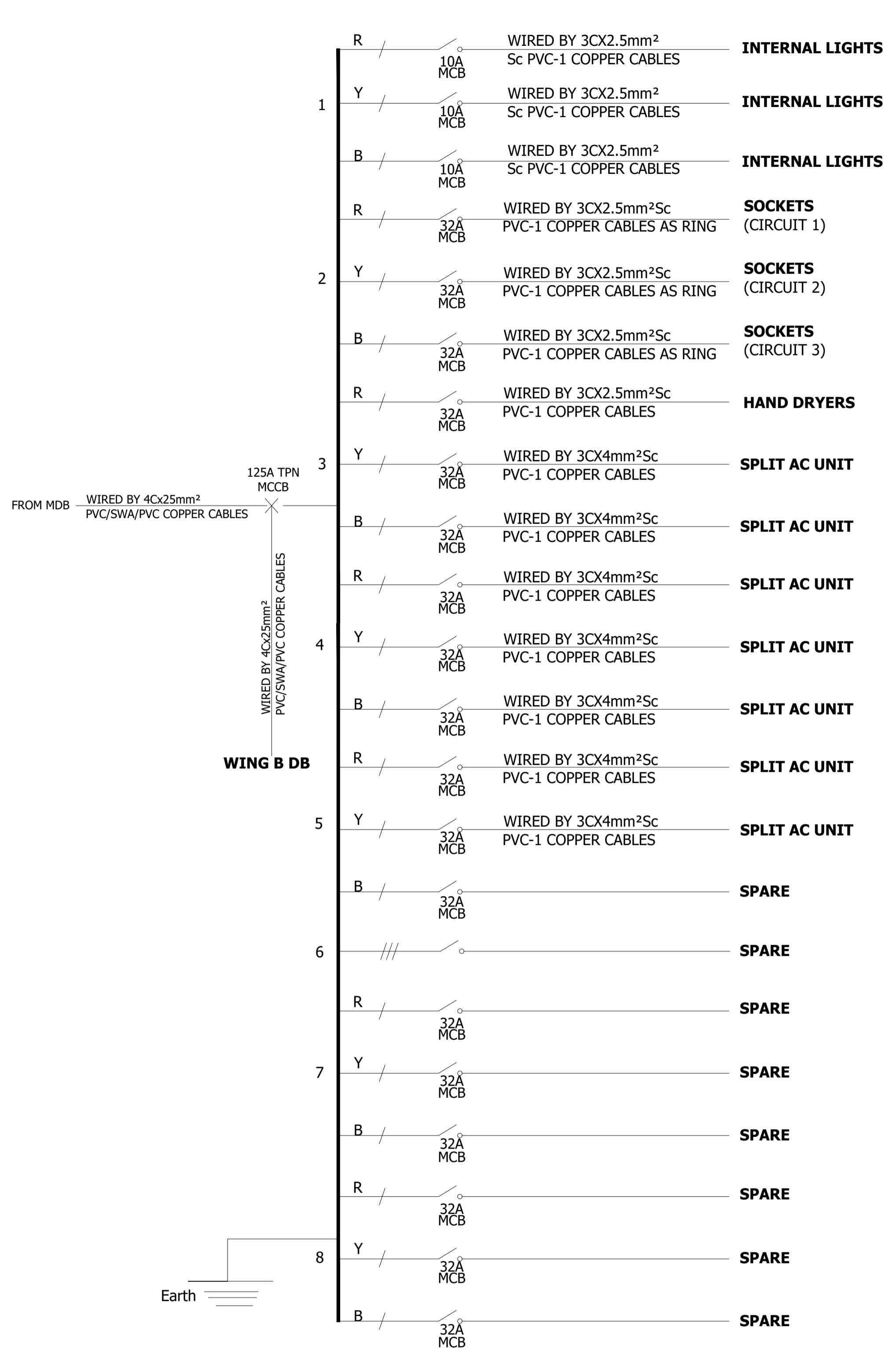

125A, 8-WAY TPN MCCB DISTRIBUTION BOARD (DB-3) RECESSED IN WALL IN DUCT ON SECOND FLOOR (WING A)

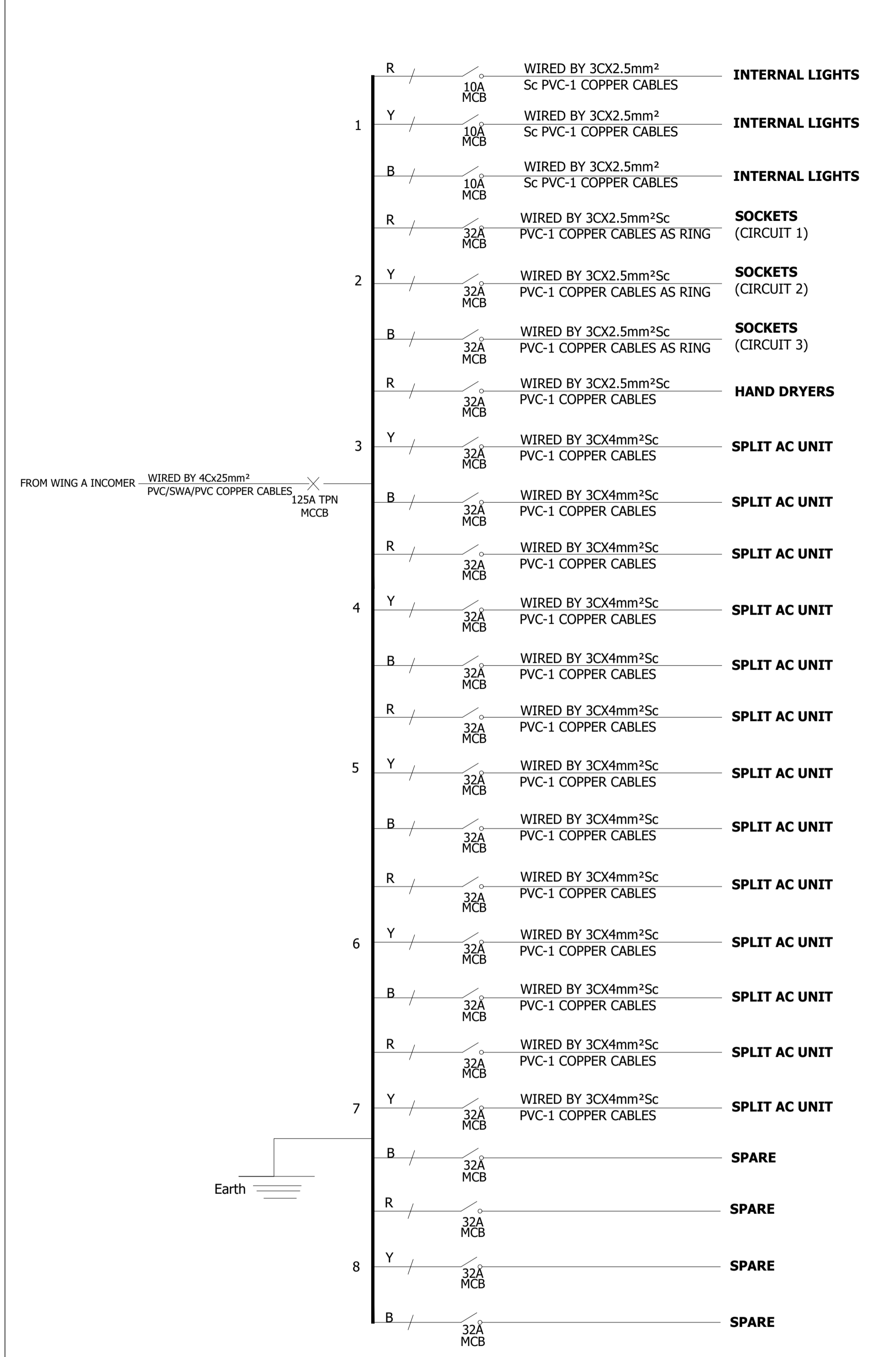

125A, 8-WAY TPN MCCB DISTRIBUTION BOARD (DB-4) RECESSED IN WALL IN DUCT ON SECOND FLOOR (WING B)

PROJECT  
**PROPOSED OFFICE DEVELOPMENT FOR UNFPA ON PLOT 61 YUSUF LULE ROAD**

CLIENT  
**UNFPA, United Nations Population Fund**  
 Kampala, Uganda

CONSULTANT  
**PROESS**  
 Consulting Engineers  
 Plot 104, Semawata Road  
 info@proess.ug  
 www.proess.ug  
 +256392178690

NO REVISIONS		
No	Date	Descriptions

DRAWING TITLE			
ELECTRICAL INSTALLATIONS: ELECTRICAL SCHEMATICS			
DESIGNED BY	DRAWN BY	JOB NO	DRG NO
CATHERINE	CATHERINE		E13
CHECKED BY	SCALE	DATE	PAPER SIZE
O.P	NTS	AUG-2024	A1

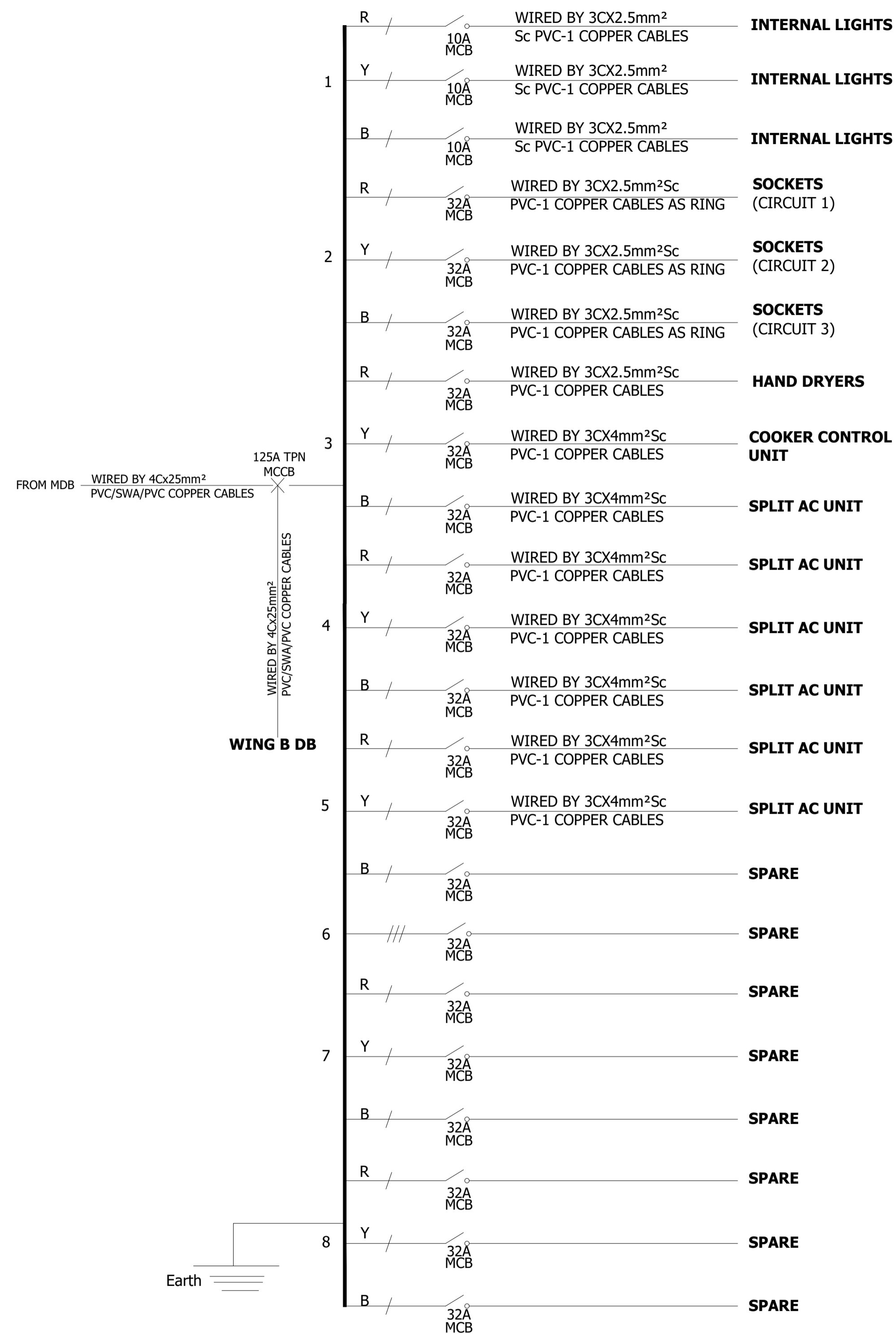

125A, 8-WAY TPN MCCB DISTRIBUTION BOARD (DB-5) RECESSED IN WALL IN DUCT ON THIRD FLOOR (WING A)

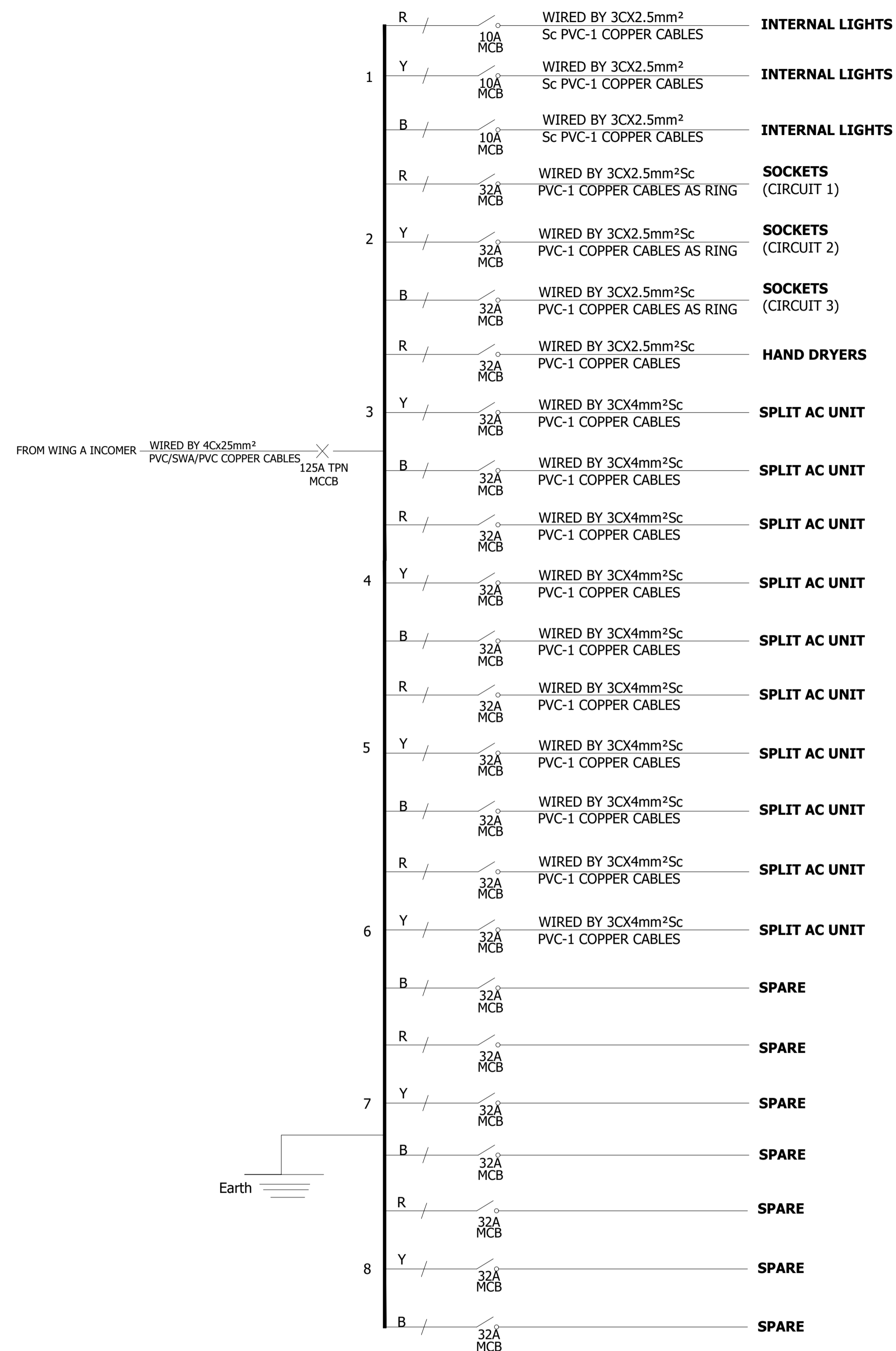

125A, 8-WAY TPN MCCB DISTRIBUTION BOARD (DB-6) RECESSED IN WALL IN DUCT ON THIRD FLOOR (WING B)

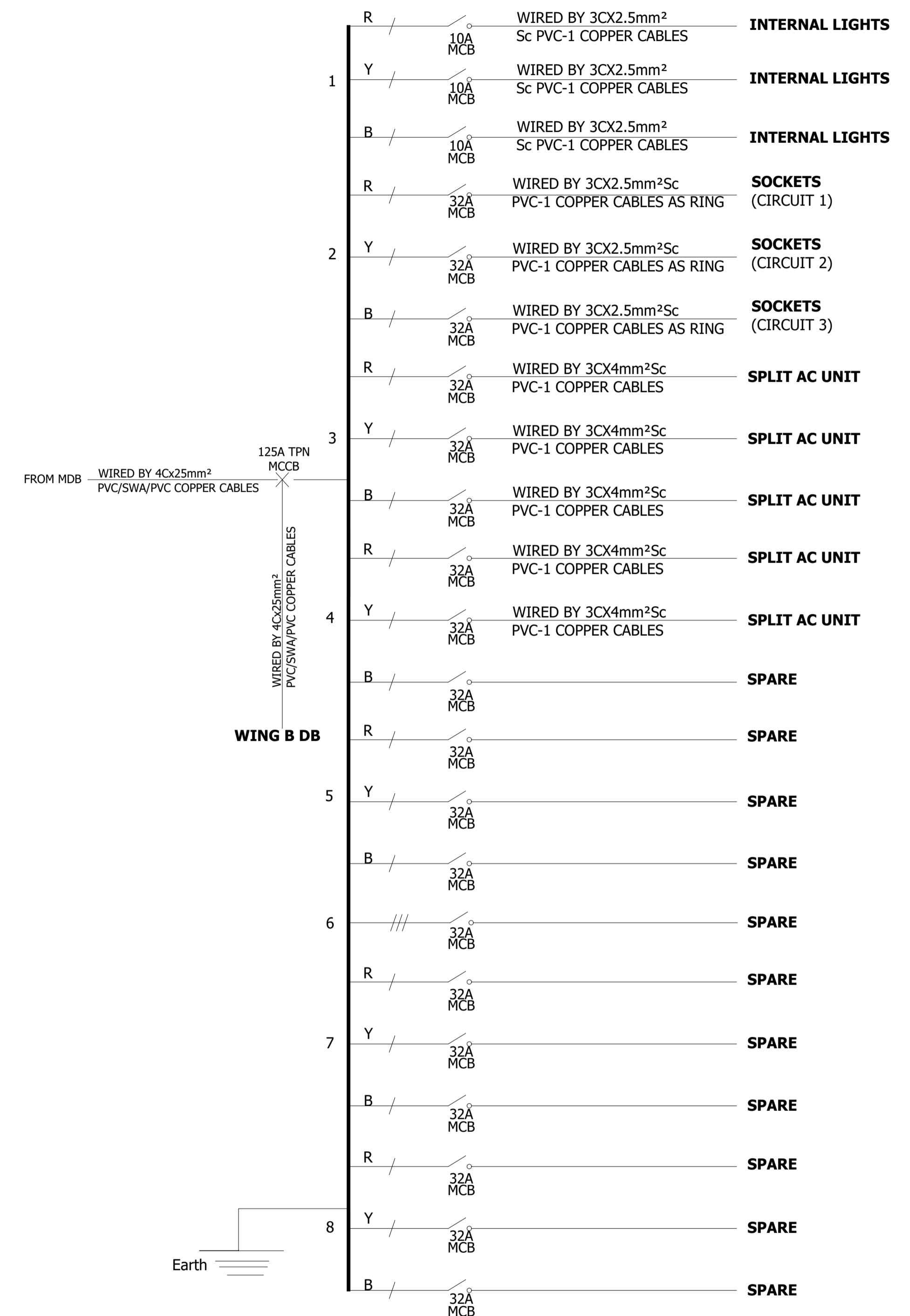

125A, 8-WAY TPN MCCB DISTRIBUTION BOARD (DB-7) RECESSED IN WALL IN DUCT ON FOURTH FLOOR (WING A)

PROJECT

PROPOSED OFFICE DEVELOPMENT FOR UNFPA ON PLOT 61 YUSUF LULE ROAD

CLIENT



UNFPA, United Nations Population Fund  
Kampala, Uganda

CONSULTANT



Plot 104, Semawata Road  
info@proess.ug  
www.proess.ug  
+256392178690

NO REVISIONS		
No	Date	Descriptions

DRAWING TITLE			
ELECTRICAL INSTALLATIONS: ELECTRICAL SCHEMATICS			
DESIGNED BY CATHERINE	DRAWN BY CATHERINE	JOB NO	DRG NO E14
CHECKED BY O.P	SCALE NTS	DATE AUG-2024	PAPER SIZE A1



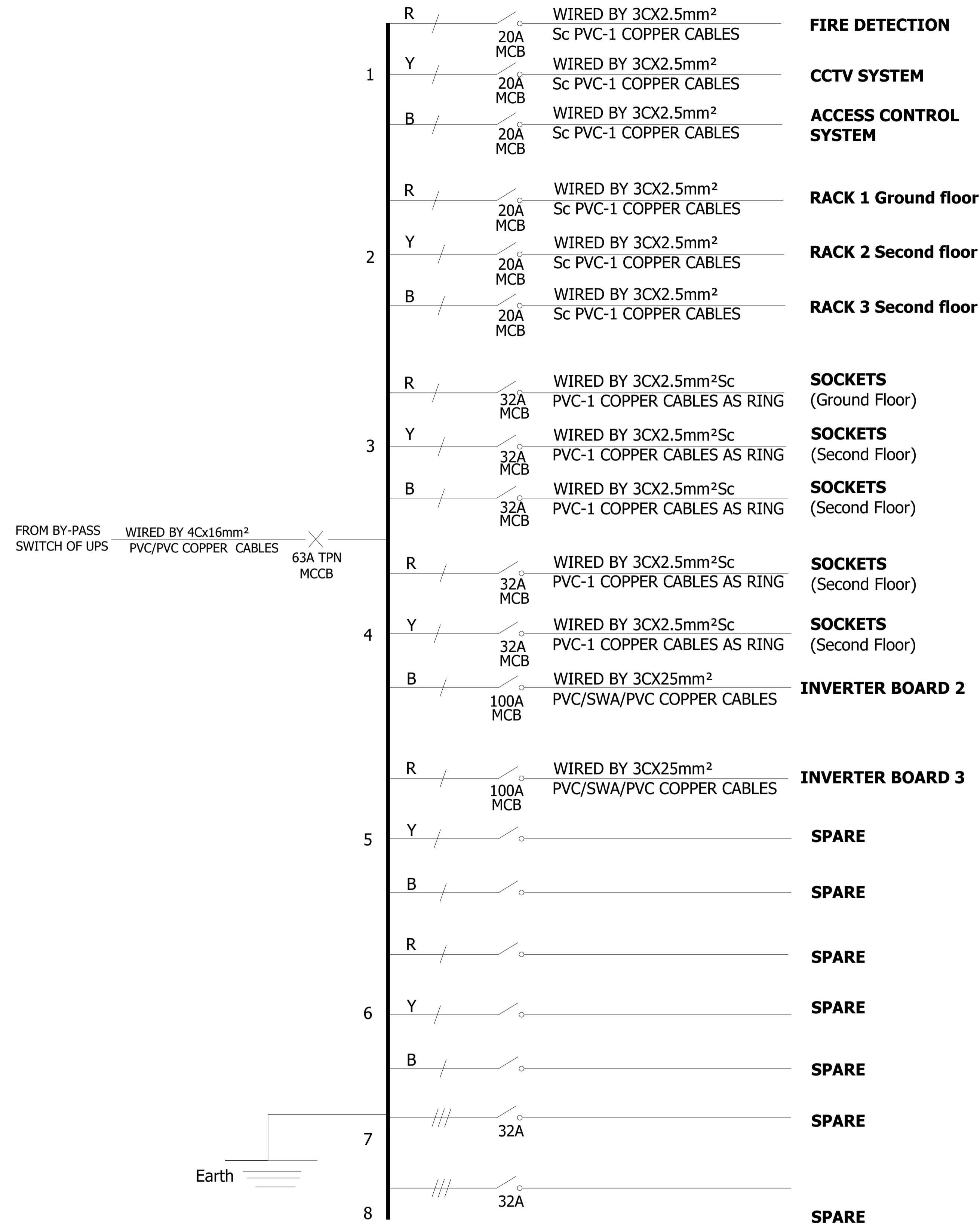

**63A, 8-WAY TPN MCCB UPS DISTRIBUTION BOARD (UPS DB-1)  
RECESSED IN WALL AS CRABTREE, HAGER OR EQUAL APPROVED  
ON SECOND FLOOR SERVER ROOM**

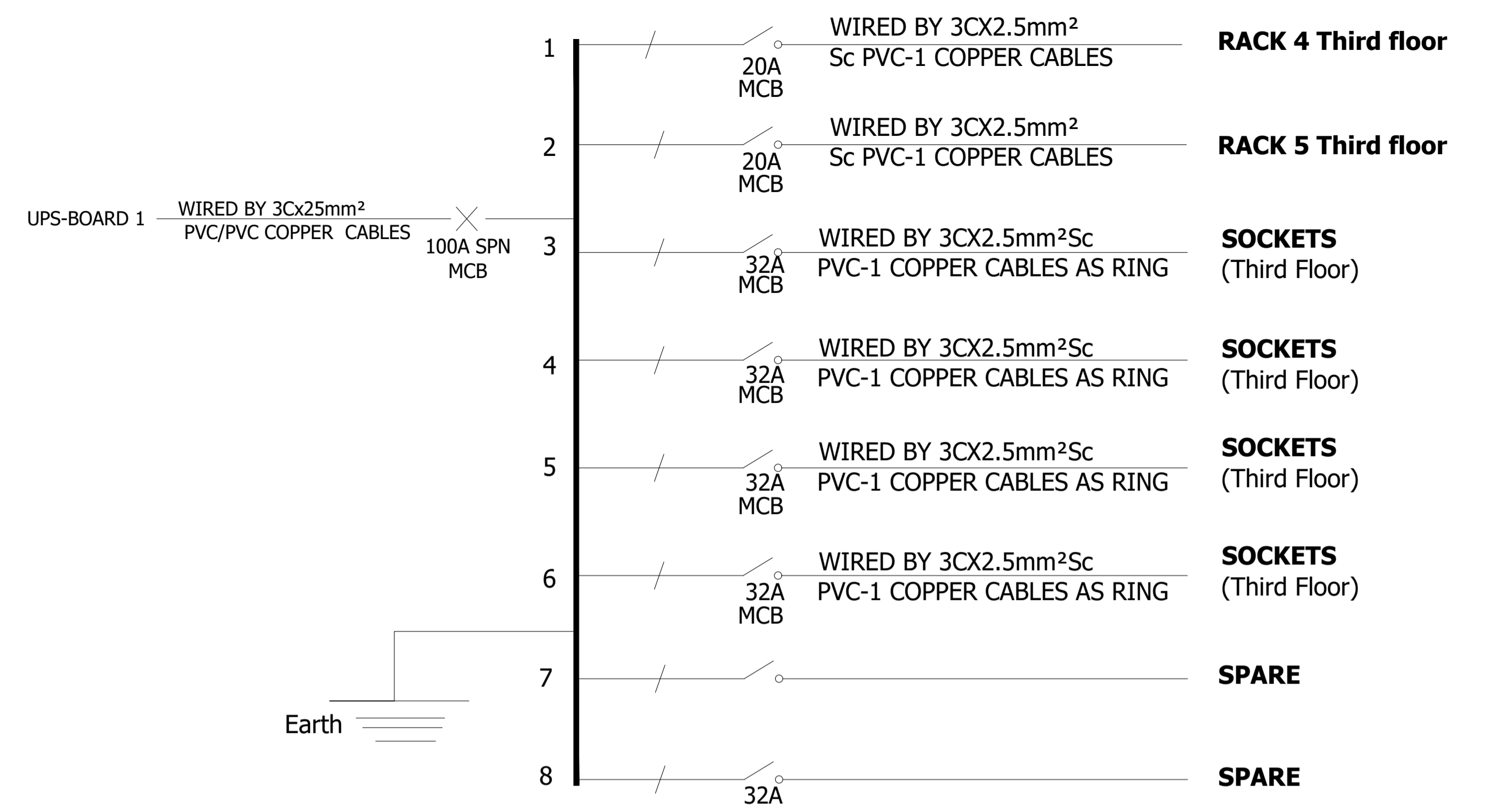

**63A, 8-WAY SPN MCCB INVERTER BOARD (UPS CU1) RECESSED IN  
WALL AS HAGER OR EQUAL APPROVED ON THIRD FLOOR**

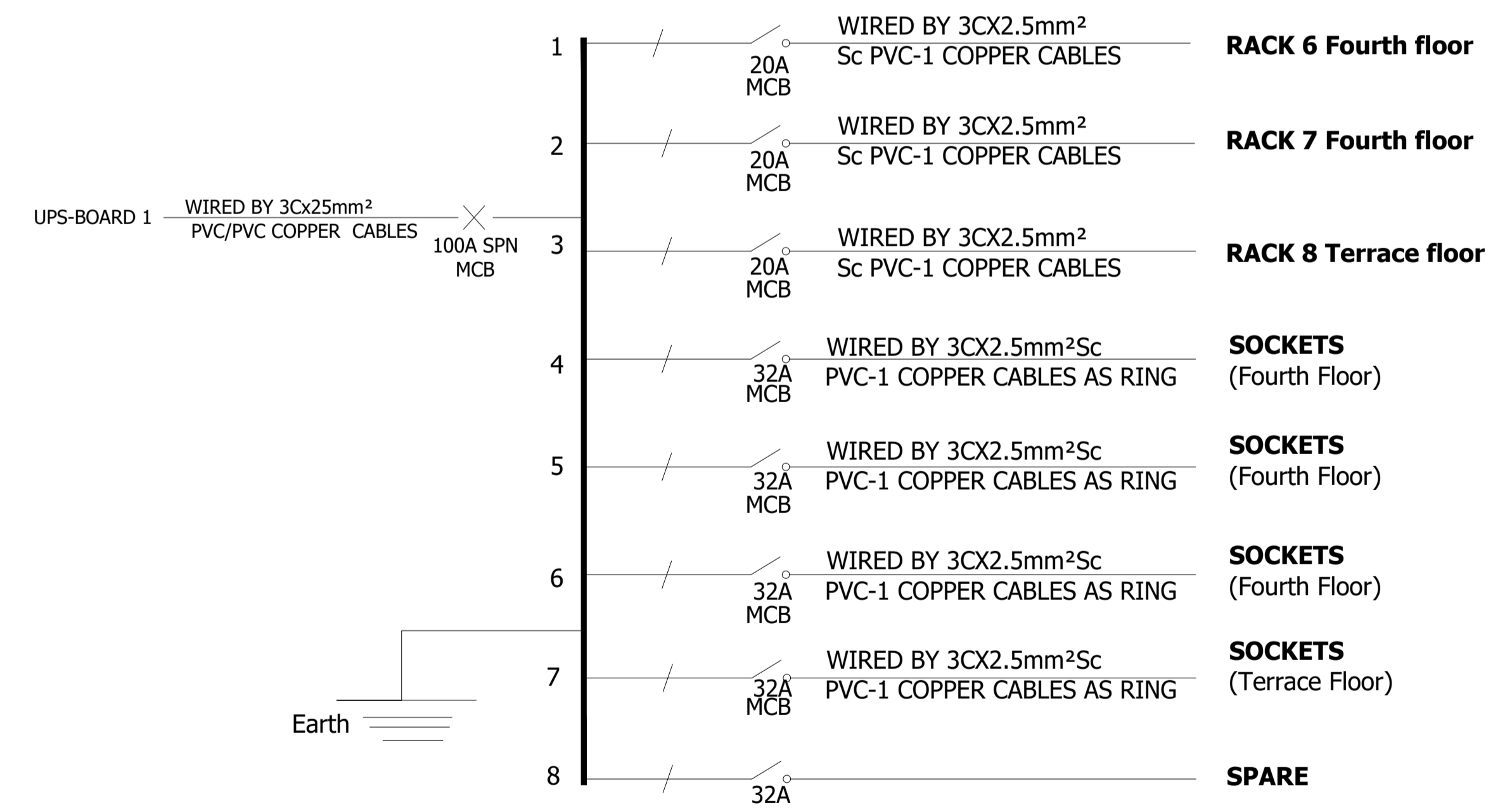

**63A, 8-WAY SPN MCCB INVERTER BOARD (UPS CU2) RECESSED IN WALL  
AS HAGER OR EQUAL APPROVED ON FOURTH FLOOR SERVER ROOM**

PROJECT  
**PROPOSED OFFICE  
DEVELOPMENT FOR UNFPA  
ON PLOT 61 YUSUF LULE ROAD**

CLIENT  
**UNFPA, United Nations  
Population Fund  
Kampala, Uganda**

CONSULTANT  
**PROESS**  
Plot 104, Semawata Road  
info@proess.ug  
www.proess.ug  
+256392178690

NO			REVISIONS			DRAWING TITLE				
No	Date	Descriptions	ELECTRICAL INSTALLATIONS: ELECTRICAL SCHEMATICS				DESIGNED BY	DRAWN BY	JOB NO	DRG NO
							CATHERINE	CATHERINE		E16
							CHECKED BY	SCALE	DATE	PAPER SIZE
							O.P	NTS	AUG-2024	A1